

COOLKILLER

CK 75^{SE} 机械键盘

快速上手指南

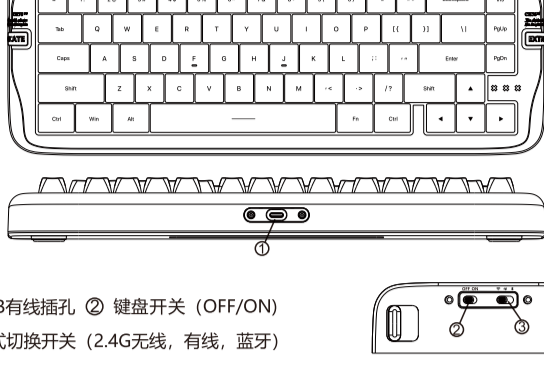

- ① USB有线插孔 ② 键盘开关 (OFF/ON)
- ③ 模式切换开关 (2.4G无线, 有线, 蓝牙)



1

包装内容



CK 75^{SE} 机械键盘



拔键器



拔轴器



合格证



2.4G接收器



Type-A to Type-C 接口线材



4颗配送轴



纸质说明书

2

参数

型号	CK75 ^{SE}
键数	80键
结构	Gasket
外壳材质	PC
PCB类型	5脚轴座热插拔
轴类型	播接轴
脚架	磁吸可替换脚架
灯光	RGB灯光
连接方式	有线、蓝牙、2.4G无线
连接端口	USB Type-C(有线模式&充电)
无线有效距离	10m内(空间开阔, 无障碍)
声音优化	Poron夹心棉; Poron轴下垫; Poron键座棉
蓝牙配对名	CK75SE 5.0
无冲键	全键无冲
上传回报率	有线及2.4G模式1000Hz; 蓝牙模式125Hz
键盘兼容系统	Windows 10-11, MacOS, iPadOS, Android, iOS
电池容量	4000 mAh
尺寸	342*148.5*40 mm
充电时间	约7小时(不开背光)
重量	1020g

3

连接2.4Ghz接收器



1.将2.4Ghz接收器连接到设备USB端口



2.键盘开机后, 模式开关拨到2.4G, 按下FN+4进入2.4G模式(指示灯绿色常亮), 长按FN+4组合键3秒进入配对模式(白灯快闪), 配对成功后4键常亮2秒, 恢复背光

4

连接有线



1.键盘开机后, 模式开关拨到有线, 进入有线模式(指示灯红色常亮), 插入TYPE-C线材连接设备



5

连接蓝牙



1. 键盘开机后, 模式开关拨到蓝牙, 按下FN+1进入蓝牙模式(指示灯蓝色常亮)



2.长按FN+1, 1键灯光快闪进入配对模式, 配对成功后, 1键常亮2秒后恢复背光。键盘配对名为: CK75SE 5.0

FN+1/2/3=Bluetooth 1/Bluetooth 2/Bluetooth 3 (按照同样的步骤, 可以连接三台不同设备。新添加设备连接前, 需要先关闭已连接设备的蓝牙功能。新设备连接成功后, 可再打开原来设备的蓝牙。切换不同设备时, 按FN+相应键。)

6

自定义驱动



国内官网: <https://www.coolkiller.cn/>



海外官网: www.coolkiller.com

扫码下载驱动程序

温馨提示: 驱动程序仅支持有线和无线模式下自定义 (MAC系统情况下仅支持有线自定义)

驱动功能

- *按键设置: 可将键值设置为其他按键, 宏定义, 快捷方式。
- *灯效设置: 切换灯效, 修改灯光颜色, 自定义灯效。
- *宏设置: 整理, 录制自定义宏。
- *延迟调节: 调节键盘的反应速度。

7

变换灯效

快捷键	功能	多少种颜色
FN+<	切换背光单色颜色	9种(自可自定义)
FN+	调节键盘灯光模式	22种(自可自定义)
FN+L	高赞灯效切换	5种(自可自定义)
FN+ENTER	关闭/打开背光	——

*自定义需要在驱动里面完成

回连

- 1.键盘开机默认上次连接的设备
- 2.FN+1、FN+2、FN+3、FN+4 (1、2、3、4键) 白灯慢闪回连
- FN+1/2/3/4=Bluetooth 1/Bluetooth 2/Bluetooth 3 /2.4G
- *键盘必须曾经配对过该装置才可实现此功能

8

储存、使用环境

温度/湿度	范围
储存温度	-20°C ~ +70°C
工作温度	-20°C ~ +60°C
储存湿度	非凝结状态下相对湿度30%RH~95%RH

充电

状态	灯亮	灯灭	待机
工作状态 (MA)	300	80	0.5
持续时间 (小时)	14	50	90天左右
充电时间 (小时)	12	7	

键盘无动作2分钟进入待机模式, 按任何键启动键盘进入工作状态。

8

通用功能快捷键

Windows快捷键	Mac快捷键
FN+1	模式开关拨到蓝牙, 短按蓝牙1/回连, 长按蓝牙1/配对
FN+2	模式开关拨到蓝牙, 短按蓝牙2/回连, 长按蓝牙2/配对
FN+3	模式开关拨到蓝牙, 短按蓝牙3/回连, 长按蓝牙3/配对
FN+4	模式开关拨到2.4G, 短按2.4G回连, 长按2.4G配对
FN+Z	WIN/MAC系统切换
FN+Y	PARTS
FN+U	SCRLK
FN+H	PAUSE
FN+N	HOME
FN+M	END
FN+<	主背光颜色切换
FN+	主背光灯效切换
FN+Win	WIN键
FN+Back	查询电量(无线模式)
FN+ENTER	关闭背光

Fn快捷键

Windows快捷键	Mac快捷键
FN+F1	多媒体
FN+F2	音量减
FN+F3	音量加
FN+F4	静音
FN+F5	上一曲
FN+F6	下一曲
FN+F7	暂停/播放
FN+F8	停止
FN+F9	邮件
FN+F10	网页
FN+F11	电脑
FN+F12	计算器
FN+ESC	长按3S, 恢复出厂设置
FN+1	背光亮度+
FN+2	背光亮度-
FN+3	背光速度+
FN+4	背光速度-

9

更换轴



轴脚与PCB板的插孔对齐后垂直下压



拔键器 拔轴器

请将拔键器的尖部对准轴体上下两端的轴体开关, 用力夹紧开关, 像使用镊子一样将轴拔出。

机械轴 轴脚 轴脚与PCB板的插孔对齐后垂直下压

可将轴脚上的轴脚帽取出, 可看到轴脚上的机械轴。

注意: 如果在插拔轴体时不慎将底部插针弄弯, 键盘按键将无法正常工作。这时请拔出轴体, 将插针轻轻捋直, 再重新插入。如果操作不当, 插针可能会受损且无法修复。安装轴体和键帽时, 请避免用力过猛, 严禁暴力安装。如有任何疑问, 请立即联系客服, 避免因操作不当导致产品损坏。

10

疑难排解

- 1.无法使用蓝牙
解决方法: 请在您的电脑或智能手机上打开蓝牙设置, 选择键盘并删除此设备或取消配对。然后, 重启您的设备, 关闭并重新打开键盘, 再尝试重新连接。
- 2.2.4 GHz或蓝牙连接受到10米范围内的干扰。
解决方法: 确保键盘未放置在可能干扰无线信号的金属表面上。
- 3.如何有效清洁键盘
*断电或断开连接: 在清洁机械键盘之前, 请务必断开键盘与电脑的连接或者关闭键盘电源, 以避免任何潜在的损坏或触电危险。
*使用适当的工具: 使用软刷、气吹罐或键盘清洁液等专门工具清洁键盘, 避免使用尖锐或硬物品, 以免损坏键帽或键盘轴。
*轻柔清洁: 在清洁过程中, 避免用力按压或拉扯键帽, 以免损坏键盘轴。
*彻底干燥: 在清洁键盘后, 确保键盘完全干燥后再连接使用, 避免发生短路或其他问题。
*避免化学品: 避免使用强烈的化学清洁剂或溶剂, 以免损坏键盘表面或造成健康危害。
*定期清洁: 定期清洁机械键盘, 可以保持键盘的使用寿命和性能。
通过遵循以上注意事项, 可以更安全有效地清洁机械键盘, 延长其使用寿命并保持良好的使用体验。

安全预防措施: 避免儿童接触产品、附件和包装材料, 以防发生意外或窒息危险。保持产品干燥, 避免受潮和腐蚀。不要将产品暴露在低于-10°C (14°F) 或高于50°C (122°F) 的极端温度环境中, 以延长键盘使用寿命。

11

东莞市叠韵创新科技有限公司

通过以下方式与我们联系
support@coolkiller.com

Coolkiller设计
中国制造

COOLKILLER
Desktop Cool Innovator

Follow US



learn more at www.coolkiller.com

12

COOLKILLER

CK 75^{SE} Mechanical Keyboard

Quick Start Guide

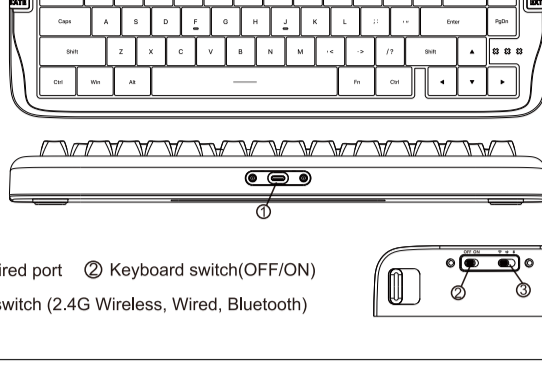

- ① USB wired port
- ② Keyboard switch(OFF/ON)
- ③ Mode switch (2.4G Wireless, Wired, Bluetooth)



1

Package contents



CK 75^{SE} Mechanical Keyboard Key Puller Switch Puller Certificate of Conformity

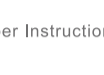
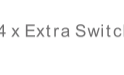

2.4G Receiver Type-A to Type-C Connector Cable 4 x Extra Switches Paper Instruction Manual

2

Parameters

Model Number	CK 75 ^{SE}
Number of keys	80
Frame work	Gasket
Shell Material	PC
PCB Typology	5-pin hot-swappable axle mount
Switch Type	Hot-swappable switches
Scaffolding	Magnetic Removable Stand
Lighting	RGB
Connector Method	Wired, Bluetooth, 2.4G wireless
Connection Port	USB Type-C(Wired Mode&Charging)
Wireless Effective Distance	Within 10m(open space,no obstacles)
Sound Optimization	Poron sandwich pad; Poron switch pad; Poron housing pad
Bluetooth Pairing Name	CK75SE 5.0
N-Key Rollover	Support
Polling Rate	Wired and 2.4G mode 1000Hz, Bluetooth mode 125Hz
Compatible System	Windows10-11, MacOS, iPadOS, Android, iOS
Battery Capacity	4000 mAh
Size	342*148.5*40 mm
Charging Time	About 7Hours (without backlight)
Weight	1020g

3

Connecting a 2.4GHz Receiver

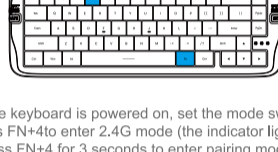
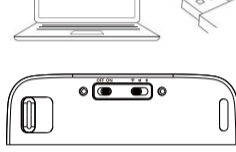

1. Connect the 2.4GHz receiver to the USB port of the device.

2. After the keyboard is powered on, set the mode switch to 2.4G and press FN+4 to enter 2.4G mode (the indicator light stays green). Long-press FN+4 for 3 seconds to enter pairing mode (white light flashes rapidly). After successful pairing, the 4 keys stay lit for 2 seconds, then the backlight resumes.

4

Wired

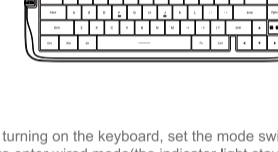
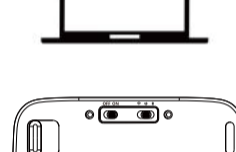

1. After turning on the keyboard, set the mode switch to Wired to enter wired mode (the indicator light stays red). Insert the Type-C cable to connect to the device.

5

Connecting Bluetooth



1. After the keyboard is powered on, set the mode switch to Bluetooth and press FN+1 to enter Bluetooth mode (the indicator light stays blue).

2. Long press FN+1. The light on the 1 key flashes rapidly to enter pairing mode. After successful pairing, the 1 key stays lit for 2 seconds, then the backlight resumes. The keyboard pairing name: CK75SE 5.0

FN+1/2/3 = Bluetooth 1/Bluetooth 2/Bluetooth 3
 (Follow the same steps to connect up to three different devices. Before connecting a new device, please turn off the Bluetooth function of the already connected device first. After the new device is successfully connected, you can turn on the Bluetooth of the original device again. To switch between different devices, press FN + the corresponding number key.)

6

Custom Drivers



Domestic Official Website:
<https://www.coolkiller.cn/>



Overseas Official Website:
www.coolkiller.com

Scan the code to download the driver

Note: The driver only supports wired and wireless customization. (Only wired customization is supported in case of MAC system)

Driver Functions

- *Key Setting: Set the key value to other keys, macros, shortcuts.
- *Lighting Settings: Switch key lighting effects, modifying lighting colors, customizing lighting effects.
- *Macro Settings: Organize and record custom macros.
- *Delay Adjustment: Adjust the response speed of the keyboard.

7

Change the lighting effect

Reconnect

1. Keyboard defaults to the last connected device upon startup.
 2. FN+1, FN+2, FN+3, FN+4 (1, 2, 3, 4 keys) white light ashes slowly when reconnection.
- (FN+1/2/3/4=Bluetooth 1/Bluetooth 2/Bluetooth 3/2.4G) ver
- *The keyboard must have been paired with the device before to realize reconnection.

Shortcut key	Functionality	How many colors
FN + <	Toggle backlight monochrome color	9 (and customizable)
FN +	Adjusting the Keyboard Lighting Mode	22 (and customizable)
FN + L	Switch Popular Light Effects	5 (and customizable)
FN + ENTER	Turn off/on backlight	—

*Customization needs to be done inside the driver

Storage and use environment

Temperature /Humidity	Realm
Storage temperature	-20°C +70°C
Operating temperature	-20°C +60°C
Storage humidity	Relative humidity under non-condensing condition 30%RH~95%RH

Battery condition

State of affairs	Lights	Lights out	Pragmatic
Operating status (MA)	300	80	0.5
Duration (hours)	14	5	About 90 days
Charging time (hours)	12	7	

The keyboard is inactive for 12 minutes to enter standby mode, press any key to activate the keypad to enter working mode.

8

General Function Shortcuts

Windows Shortcut Key	Mac Shortcut Key
FN+1 Set the mode switch to Bluetooth. Short press Bluetooth 1 to reconnect, long press Bluetooth 1 to pair.	FN+1 Set the mode switch to Bluetooth. Short press Bluetooth 1 to reconnect, long press Bluetooth 1 to pair.
FN+2 Set the mode switch to Bluetooth. Short press Bluetooth 2 to reconnect, long press Bluetooth 2 to pair.	FN+2 Set the mode switch to Bluetooth. Short press Bluetooth 2 to reconnect, long press Bluetooth 2 to pair.
FN+3 Set the mode switch to Bluetooth. Short press Bluetooth 3 to reconnect, long press Bluetooth 3 to pair.	FN+3 Set the mode switch to Bluetooth. Short press Bluetooth 3 to reconnect, long press Bluetooth 3 to pair.
FN+4 Set the mode switch to 2.4G. Short press 2.4G to reconnect, long press 2.4G to pair.	FN+4 Set the mode switch to 2.4G. Short press 2.4G to reconnect, long press 2.4G to pair.
FN+Z WIN/MAC System Switch	FN+Z WIN/MAC System Switch
FN+Y PARTSC	FN+Y PARTSC
FN+U SCRLLK	FN+U SCRLLK
FN+H PAUSE	FN+H PAUSE
FN+N HOME	FN+N HOME
FN+M END	FN+M END
FN+< Main Backlight Color Switch	FN+< Main Backlight Color Switch
FN+ Main Backlight Effect Switch	FN+ Main Backlight Effect Switch
F N+Win WIN Lock	FN+Win None
N+Back Check Battery Level (Wireless Mode)	FN+Back Check Battery Level (Wireless Mode)
FN+ENTER Turn off the backlight	FN+ENTER Turn off the backlight

Fn Shortcut key

Windows Shortcut Key	Mac Shortcut Key
FN+F1 Multimedia	FN+F1 F1
FN+F2 Volume Decrease	FN+F2 F2
FN+F3 Volume Increase	FN+F3 F3
FN+F4 Mute/Unmute	FN+F4 F4
FN+F5 Next Song	FN+F5 F5
FN+F6 Previous Song	FN+F6 F6
FN+F7 Pause/Play	FN+F7 F7
FN+F8 Cease/Stop	FN+F8 F8
FN+F9 Mails	FN+F9 F9
FN+F10 Web Page	FN+F10 F10
FN+F11 Laptops	FN+F11 F11
FN+F12 Calculators	FN+F12 F12
FN+ESC Long press 3S to restore	FN+ESC Long press 3S to restore
FN+Z System Integrator	FN+Z System Integrator
FN+1 Backlight Brightness+	FN+1 Backlight Brightness+
FN+ Backlight Brightness-	FN+ Backlight Brightness-
FN+< Backlight Speed-	FN+< Backlight Speed-
FN+> Backlight Speed+	FN+> Backlight Speed+

9

Replacement of switch

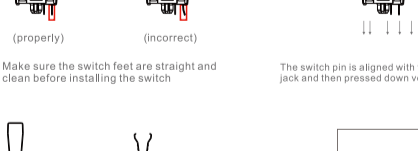

Make sure the switch feet are straight and clean before installing the switch. The switch pin is aligned with the PCB board's jack and then pressed down vertically.

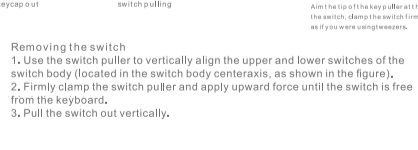

1. Remove the switch puller
2. Use the switch puller to vertically align the upper and lower switches of the switch body (located in the switch body center axis, as shown in the figure).
3. Firmly clamp the switch puller and apply upward force until the switch is free from the keyboard.
4. Pull the switch out vertically.

Note: If the bottom pins are accidentally bent when inserting or removing the switch, the keyboard keys will not work properly. In this case, please pull out the switch, gently straighten the pins, and then insert it again. If you do this incorrectly, the pins may be damaged beyond repair. When installing the switch and keycaps, avoid using excessive force and do not install them violently. If you have any questions, please contact customer service immediately, to avoid improper operation resulting in product damage.

10

Troubleshooting

1. Unable to use Bluetooth
 Solution: Please open the Bluetooth settings on your computer or smartphone, select "Keyboard" and delete this device or unpair it. Then, restart your device, turn off and back on the keyboard and try to reconnect again.
2. 2.4 GHz or Bluetooth connection is interfered with within 10 metres
 Solution: Make sure the keyboard is not placed on a metal surface that may interfere with the wireless signal.
3. How to clean the keyboard effectively
 *Power off or disconnection: Before cleaning your mechanical keyboard, be sure to disconnect the keyboard from your computer or switch off the power to the keyboard to avoid any potential damage or risk of electric shock.
 *Use appropriate tools: Use specialised tools such as soft brushes, air blow canisters or keyboard cleaning gels to clean your keyboard, avoid using sharp or hard objects that may damage the keycaps or switch.
 *Clean gently: Avoid pressing or pulling on the keycaps during the cleaning process to avoid damaging the keyboard switch.
 *Thoroughly dry: After cleaning the keyboard, make sure it is completely dry before connecting it to the computer to avoid short circuits or other problems.
 *Avoid chemicals: Avoid using strong chemical cleaners or solvents that may damage the surface of the keyboard or cause health hazards.
 *Clean regularly: Regular cleaning of your mechanical keyboard will maintain its longevity and performance.
 *By following the above precautions, your clean your mechanical keyboard more safely and effectively, extending its life and maintaining a good user experience.

Safety Precautions:
 Avoid child contact with the product, accessories and packaging materials to prevent accidents or choking hazards.
 Keep the product dry to avoid moisture and corrosion.
 Do not expose the product to extreme temperatures below -10°C (14°F) or above 50°C (122°F) to extend the life of the keyboard.

11

Dongguan Nexa Sound Innovation Technology Co., Ltd
 Contact us via support@coolkiller.com
 Designed by Coolkiller
 Made in China

COOLKILLER
 Desktop Cool Innovator

Follow US



learn more at www.coolkiller.com

12