

COOLKILLER

CK 75^{SE} Mechanical Keyboard

Quick Start Guide

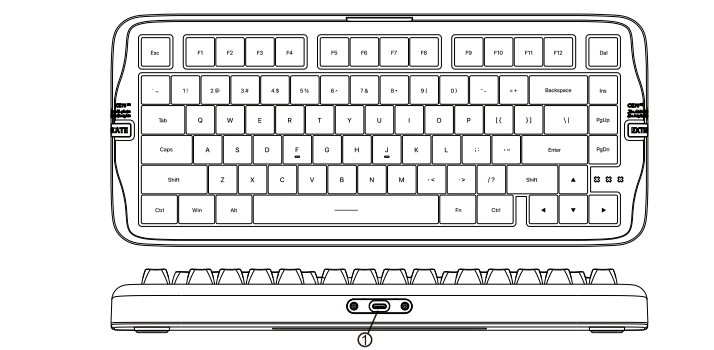

- ① USB wired port
- ② Keyboard switch(OFF/ON)
- ③ Mode switch (2.4G Wireless, Wired, Bluetooth)

1

Package contents



CK 75^{SE} Mechanical Keyboard



Key Puller



Switch Puller



Certificate of Conformity

2.4G Receiver

Type-A to Type-C Connector Cable

4 x Extra Switches

Paper Instruction Manual

2

Parameters

Model Number	CK 75 ^{SE}
Model Name	SE
Frame Work	Stainless
Shell Material	PC
PCB Material	High temperature ABS resin
Switch Type	Hot-swappable switch
Switching	Mechanical Membrane Board
Lighting	RGB
Connector Method	Wired, Bluetooth, 2.4G wireless
Connector Port	USB Type-C/USB-A/Bluetooth
Product Features	Wireless, Hot-swappable switch, RGB
Sound Optimization	Power switch/pair, Power switch/pair, Power switch/pair
Bluetooth pairing status	100% success
Radio Protocol	Bluetooth
Working Rate	Wired and 2.4G mode 1000Hz; Bluetooth mode 125Hz
Connection System	Windows 10, Windows 11, macOS, iOS, Android, etc.
Battery Capacity	4000 mAh
Charging Time	200-180min
Working Time	More than 100h (without backlight)
Weight	1000g

3

Connecting a 2.4GHz Receiver



1. Connect the 2.4GHz receiver to the USB port of the device.



2. After the keyboard is powered on, set the mode switch to 2.4G and press FN+4 to enter 2.4G mode (the indicator light stays green). Longpress FN+4 for 3 seconds to enter pairing mode (white light flashes rapidly). After successful pairing, the 4 keys stay lit for 2 seconds, then the backlight resumes.

4

Wired

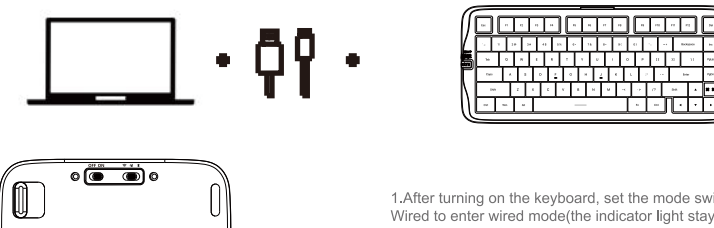

1. After turning on the keyboard, set the mode switch to Wired to enter wired mode (the indicator light stays red). Insert the Type-C cable to connect to the device.

5

Connecting Bluetooth



1. After the keyboard is powered on, set the mode switch to Bluetooth and press FN+1 to enter Bluetooth mode (the indicator light stays blue).

2. Long press FN+1. The light on the 1 key flashes rapidly to enter pairing mode. After successful pairing, the 1 key stays lit for 2 seconds, then the backlight resumes. The keyboard pairing name: CK75SE 5.0

FN+10 = Bluetooth 10 Bluetooth 10 Bluetooth 5
Please be aware that the device is not a Bluetooth device. Before connecting with other devices, please enter the Bluetooth function of the already connected device first. After the new device is successfully connected, you can turn on the Bluetooth of the original device again. To switch between different devices, press FN+10 (the corresponding number key).

6

Custom Drivers

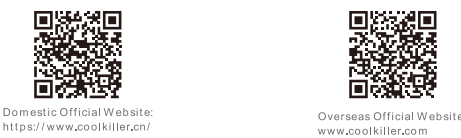

Scan the code to download the driver

Note: The driver only supports wired and Bluetooth. (Only wired customization is supported in case of MAC system)

Driver Functions
*Key Setting: Set the key value to other keys, macros, shortcuts.
*Lighting Settings: Switching lighting effects, modifying lighting colors, customizing lighting effects.
*Macro Settings: Organize and record custom macros.
*Delay Adjustment: Adjust the response speed of the keyboard.

Change the lighting effect

Bluetooth key	Functionality	Show any colors
FN+1	Toggle backlight on/off (chrome color)	12 (and customizable)
FN+2	Adjusting the keyboard lighting mode	22 (and customizable)
FN+3	Switch Popular Light Effect	12 (and customizable)
FN+ENTER	Turn off/on backlight	

*Customization needs to be done inside the driver

Reconnect

1. Keyboard defaults to the last connected device upon startup.
2. FN+1, FN+2, FN+3, FN+4 (1, 2, 3, 4 keys) white light flashes slowly when reconnection.
(FN+1/2/3/4+Bluetooth 1/Bluetooth 2/Bluetooth 3/2.4G) ver
*The keyboard must have been paired with the device before to realize reconnection.

Battery condition

State of affairs	Light	Lightout	Program
Capacity (%)	100	60	5.0
Duration (hours)	14	33	At least 30 days
Charging time (hours)	12	7	

The treatment is suitable for 2 minutes to enter standby mode, and any way to indicate the keyboard to enter working mode.

8

General Function Shortcuts

Windows Shortcut Key	Mac Shortcut Key
FN+1: Windows Start/End	FN+1: Command+Space
FN+2: Windows Search	FN+2: Command+Space
FN+3: Windows Task View	FN+3: Command+Tab
FN+4: Windows Home	FN+4: Command+Esc
FN+5: Windows Previous Window	FN+5: Command+Option+Left Arrow
FN+6: Windows Next Window	FN+6: Command+Option+Right Arrow
FN+7: Windows Refresh	FN+7: Command+R
FN+8: Windows Volume Up	FN+8: Command+Option+Up Arrow
FN+9: Windows Volume Down	FN+9: Command+Option+Down Arrow
FN+10: Windows Mute	FN+10: Command+Option+F3
FN+11: Windows Sleep	FN+11: Command+Option+Power
FN+12: Windows Lock	FN+12: Command+Option+L
FN+13: Windows Calculator	FN+13: Command+Shift+Q
FN+14: Windows Task Manager	FN+14: Command+Shift+Esc
FN+15: Windows Settings	FN+15: Command+Space
FN+16: Windows File Explorer	FN+16: Command+Shift+E
FN+17: Windows Edge	FN+17: Command+Shift+I
FN+18: Windows Chrome	FN+18: Command+Shift+J
FN+19: Windows Firefox	FN+19: Command+Shift+K
FN+20: Windows Opera	FN+20: Command+Shift+L
FN+21: Windows Safari	FN+21: Command+Shift+M
FN+22: Windows Mail	FN+22: Command+Shift+N
FN+23: Windows Photos	FN+23: Command+Shift+O
FN+24: Windows Music	FN+24: Command+Shift+P
FN+25: Windows Store	FN+25: Command+Shift+Q
FN+26: Windows OneDrive	FN+26: Command+Shift+R
FN+27: Windows File History	FN+27: Command+Shift+S
FN+28: Windows Backup and Restore	FN+28: Command+Shift+T
FN+29: Windows Device Manager	FN+29: Command+Shift+U
FN+30: Windows System Restore	FN+30: Command+Shift+V
FN+31: Windows Windows Update	FN+31: Command+Shift+W
FN+32: Windows Windows Defender	FN+32: Command+Shift+X
FN+33: Windows Windows Firewall	FN+33: Command+Shift+Y
FN+34: Windows Windows Security	FN+34: Command+Shift+Z
FN+35: Windows Windows Defender Security Center	FN+35: Command+Shift+[
FN+36: Windows Windows Defender SmartScreen	FN+36: Command+Shift+]
FN+37: Windows Windows Defender Security Center	FN+37: Command+Shift+`
FN+38: Windows Windows Defender Security Center	FN+38: Command+Shift+~
FN+39: Windows Windows Defender Security Center	FN+39: Command+Shift+^
FN+40: Windows Windows Defender Security Center	FN+40: Command+Shift+_
FN+41: Windows Windows Defender Security Center	FN+41: Command+Shift+=
FN+42: Windows Windows Defender Security Center	FN+42: Command+Shift+>
FN+43: Windows Windows Defender Security Center	FN+43: Command+Shift+<
FN+44: Windows Windows Defender Security Center	FN+44: Command+Shift+~
FN+45: Windows Windows Defender Security Center	FN+45: Command+Shift+`
FN+46: Windows Windows Defender Security Center	FN+46: Command+Shift+^
FN+47: Windows Windows Defender Security Center	FN+47: Command+Shift+=
FN+48: Windows Windows Defender Security Center	FN+48: Command+Shift+>
FN+49: Windows Windows Defender Security Center	FN+49: Command+Shift+<
FN+50: Windows Windows Defender Security Center	FN+50: Command+Shift+~
FN+51: Windows Windows Defender Security Center	FN+51: Command+Shift+`
FN+52: Windows Windows Defender Security Center	FN+52: Command+Shift+^
FN+53: Windows Windows Defender Security Center	FN+53: Command+Shift+=
FN+54: Windows Windows Defender Security Center	FN+54: Command+Shift+>
FN+55: Windows Windows Defender Security Center	FN+55: Command+Shift+<
FN+56: Windows Windows Defender Security Center	FN+56: Command+Shift+~
FN+57: Windows Windows Defender Security Center	FN+57: Command+Shift+`
FN+58: Windows Windows Defender Security Center	FN+58: Command+Shift+^
FN+59: Windows Windows Defender Security Center	FN+59: Command+Shift+=
FN+60: Windows Windows Defender Security Center	FN+60: Command+Shift+>
FN+61: Windows Windows Defender Security Center	FN+61: Command+Shift+<
FN+62: Windows Windows Defender Security Center	FN+62: Command+Shift+~
FN+63: Windows Windows Defender Security Center	FN+63: Command+Shift+`
FN+64: Windows Windows Defender Security Center	FN+64: Command+Shift+^
FN+65: Windows Windows Defender Security Center	FN+65: Command+Shift+=
FN+66: Windows Windows Defender Security Center	FN+66: Command+Shift+>
FN+67: Windows Windows Defender Security Center	FN+67: Command+Shift+<
FN+68: Windows Windows Defender Security Center	FN+68: Command+Shift+~
FN+69: Windows Windows Defender Security Center	FN+69: Command+Shift+`
FN+70: Windows Windows Defender Security Center	FN+70: Command+Shift+^
FN+71: Windows Windows Defender Security Center	FN+71: Command+Shift+=
FN+72: Windows Windows Defender Security Center	FN+72: Command+Shift+>
FN+73: Windows Windows Defender Security Center	FN+73: Command+Shift+<
FN+74: Windows Windows Defender Security Center	FN+74: Command+Shift+~
FN+75: Windows Windows Defender Security Center	FN+75: Command+Shift+`
FN+76: Windows Windows Defender Security Center	FN+76: Command+Shift+^
FN+77: Windows Windows Defender Security Center	FN+77: Command+Shift+=
FN+78: Windows Windows Defender Security Center	FN+78: Command+Shift+>
FN+79: Windows Windows Defender Security Center	FN+79: Command+Shift+<
FN+80: Windows Windows Defender Security Center	FN+80: Command+Shift+~
FN+81: Windows Windows Defender Security Center	FN+81: Command+Shift+`
FN+82: Windows Windows Defender Security Center	FN+82: Command+Shift+^
FN+83: Windows Windows Defender Security Center	FN+83: Command+Shift+=
FN+84: Windows Windows Defender Security Center	FN+84: Command+Shift+>
FN+85: Windows Windows Defender Security Center	FN+85: Command+Shift+<
FN+86: Windows Windows Defender Security Center	FN+86: Command+Shift+~
FN+87: Windows Windows Defender Security Center	FN+87: Command+Shift+`
FN+88: Windows Windows Defender Security Center	FN+88: Command+Shift+^
FN+89: Windows Windows Defender Security Center	FN+89: Command+Shift+=
FN+90: Windows Windows Defender Security Center	FN+90: Command+Shift+>
FN+91: Windows Windows Defender Security Center	FN+91: Command+Shift+<
FN+92: Windows Windows Defender Security Center	FN+92: Command+Shift+~
FN+93: Windows Windows Defender Security Center	FN+93: Command+Shift+`
FN+94: Windows Windows Defender Security Center	FN+94: Command+Shift+^
FN+95: Windows Windows Defender Security Center	FN+95: Command+Shift+=
FN+96: Windows Windows Defender Security Center	FN+96: Command+Shift+>
FN+97: Windows Windows Defender Security Center	FN+97: Command+Shift+<
FN+98: Windows Windows Defender Security Center	FN+98: Command+Shift+~
FN+99: Windows Windows Defender Security Center	FN+99: Command+Shift+`
FN+100: Windows Windows Defender Security Center	FN+100: Command+Shift+^

Fn Shortcut key

Windows Shortcut Key	Mac Shortcut Key
FN+1: Windows Start/End	FN+1: Command+Space
FN+2: Windows Search	FN+2: Command+Space
FN+3: Windows Task View	FN+3: Command+Tab
FN+4: Windows Home	FN+4: Command+Esc
FN+5: Windows Previous Window	FN+5: Command+Option+Left Arrow
FN+6: Windows Next Window	FN+6: Command+Option+Right Arrow
FN+7: Windows Refresh	FN+7: Command+R
FN+8: Windows Volume Up	FN+8: Command+Option+Up Arrow
FN+9: Windows Volume Down	FN+9: Command+Option+Down Arrow
FN+10: Windows Mute	FN+10: Command+Option+F3
FN+11: Windows Sleep	FN+11: Command+Option+Power
FN+12: Windows Lock	FN+12: Command+Option+L
FN+13: Windows Calculator	FN+13: Command+Shift+Q
FN+14: Windows Task Manager	FN+14: Command+Shift+Esc
FN+15: Windows Settings	FN+15: Command+Space
FN+16: Windows File Explorer	FN+16: Command+Shift+E
FN+17: Windows Edge	FN+17: Command+Shift+I
FN+18: Windows Chrome	FN+18: Command+Shift+J
FN+19: Windows Firefox	FN+19: Command+Shift+K
FN+20: Windows Opera	FN+20: Command+Shift+L
FN+21: Windows Safari	FN+21: Command+Shift+M
FN+22: Windows Mail	FN+22: Command+Shift+N
FN+23: Windows Photos	FN+23: Command+Shift+O
FN+24: Windows Music	FN+24: Command+Shift+P
FN+25: Windows Store	FN+25: Command+Shift+Q
FN+26: Windows OneDrive	FN+26: Command+Shift+R
FN+27: Windows File History	FN+27: Command+Shift+S
FN+28: Windows Backup and Restore	FN+28: Command+Shift+T
FN+29: Windows Device Manager	FN+29: Command+Shift+U
FN+30: Windows System Restore	FN+30: Command+Shift+V
FN+31: Windows Windows Update	FN+31: Command+Shift+W
FN+32: Windows Windows Defender	FN+32: Command+Shift+X
FN+33: Windows Windows Firewall	FN+33: Command+Shift+Y
FN+34: Windows Windows Security	FN+34: Command+Shift+Z
FN+35: Windows Windows Defender Security Center	FN+35: Command+Shift+[
FN+36: Windows Windows Defender SmartScreen	FN+36: Command+Shift+]
FN+37: Windows Windows Defender Security Center	FN+37: Command+Shift+`
FN+38: Windows Windows Defender Security Center	FN+38: Command+Shift+^
FN+39: Windows Windows Defender Security Center	FN+39: Command+Shift+=
FN+40: Windows Windows Defender Security Center	FN+40: Command+Shift+>
FN+41: Windows Windows Defender Security Center	FN+41: Command+Shift+<
FN+42: Windows Windows Defender Security Center	FN+42: Command+Shift+~
FN+43: Windows Windows Defender Security Center	FN+43: Command+Shift+`
FN+44: Windows Windows Defender Security Center	FN+44: Command+Shift+^
FN+45: Windows Windows Defender Security Center	FN+45: Command+Shift+=
FN+46: Windows Windows Defender Security Center	FN+46: Command+Shift+>
FN+47: Windows Windows Defender Security Center	FN+47: Command+Shift+<
FN+48: Windows Windows Defender Security Center	FN+48: Command+Shift+~
FN+49: Windows Windows Defender Security Center	FN+49: Command+Shift+`
FN+50: Windows Windows Defender Security Center	FN+50: Command+Shift+^
FN+51: Windows Windows Defender Security Center	FN+51: Command+Shift+=
FN+52: Windows Windows Defender Security Center	FN+52: Command+Shift+>
FN+53: Windows Windows Defender Security Center	FN+53: Command+Shift+<
FN+54: Windows Windows Defender Security Center	FN+54: Command+Shift+~
FN+55: Windows Windows Defender Security Center	FN+55: Command+Shift+`
FN+56: Windows Windows Defender Security Center	FN+56: Command+Shift+^
FN+57: Windows Windows Defender Security Center	FN+57: Command+Shift+=
FN+58: Windows Windows Defender Security Center	FN+58: Command+Shift+>
FN+59: Windows Windows Defender Security Center	FN+59: Command+Shift+<
FN+60: Windows Windows Defender Security Center	FN+60: Command+Shift+~
FN+61: Windows Windows Defender Security Center	FN+61: Command+Shift+`
FN+62: Windows Windows Defender Security Center	FN+62: Command+Shift+^
FN+63: Windows Windows Defender Security Center	FN+63: Command+Shift+=
FN+64: Windows Windows Defender Security Center	FN+64: Command+Shift+>
FN+65: Windows Windows Defender Security Center	FN+65: Command+Shift+<
FN+66: Windows Windows Defender Security Center	FN+66: Command+Shift+~
FN+67: Windows Windows Defender Security Center	FN+67: Command+Shift+`
FN+68: Windows Windows Defender Security Center	FN+68: Command+Shift+^
FN+69: Windows Windows Defender Security Center	FN+69: Command+Shift+=
FN+70: Windows Windows Defender Security Center	FN+70: Command+Shift+>
FN+71: Windows Windows Defender Security Center	FN+71: Command+Shift+<
FN+72: Windows Windows Defender Security Center	FN+72: Command+Shift+~
FN+73: Windows Windows Defender Security Center	FN+73: Command+Shift+`
FN+74: Windows Windows Defender Security Center	FN+74: Command+Shift+^
FN+75: Windows Windows Defender Security Center	FN+75: Command+Shift+=
FN+76: Windows Windows Defender Security Center	FN+76: Command+Shift+>
FN+77: Windows Windows Defender Security Center	FN+77: Command+Shift+<
FN+78: Windows Windows Defender Security Center	FN+78: Command+Shift+~
FN+79: Windows Windows Defender Security Center	FN+79: Command+Shift+`
FN+80: Windows Windows Defender Security Center	FN+80: Command+Shift+^
FN+81: Windows Windows Defender Security Center	FN+81: Command+Shift+=
FN+82: Windows Windows Defender Security Center	FN+82: Command+Shift+>
FN+83: Windows Windows Defender Security Center	FN+83: Command+Shift+<
FN+84: Windows Windows Defender Security Center	FN+84: Command+Shift+~
FN+85: Windows Windows Defender Security Center	FN+85: Command+Shift+`
FN+86: Windows Windows Defender Security Center	FN+86: Command+Shift+^
FN+87: Windows Windows Defender Security Center	FN+87: Command+Shift+=
FN+88: Windows Windows Defender Security Center	FN+88: Command+Shift+>
FN+89: Windows Windows Defender Security Center	FN+89: Command+Shift+<
FN+90: Windows Windows Defender Security Center	FN+90: Command+Shift+~
FN+91: Windows Windows Defender Security Center	FN+91: Command+Shift+`
FN+92: Windows Windows Defender Security Center	FN+92: Command+Shift+^
FN+93: Windows Windows Defender Security Center	FN+93: Command+Shift+=
FN+94: Windows Windows Defender Security Center	FN+94: Command+Shift+>
FN+95: Windows Windows Defender Security Center	FN+95: Command+Shift+<
FN+96: Windows Windows Defender Security Center	FN+96: Command+Shift+~
FN+97: Windows Windows Defender Security Center	FN+97: Command+Shift+`
FN+98: Windows Windows Defender Security Center	FN+98: Command+Shift+^
FN+99: Windows Windows Defender Security Center	FN+99: Command+Shift+=
FN+100: Windows Windows Defender Security Center	FN+100: Command+Shift+>

9

Replacement of switch

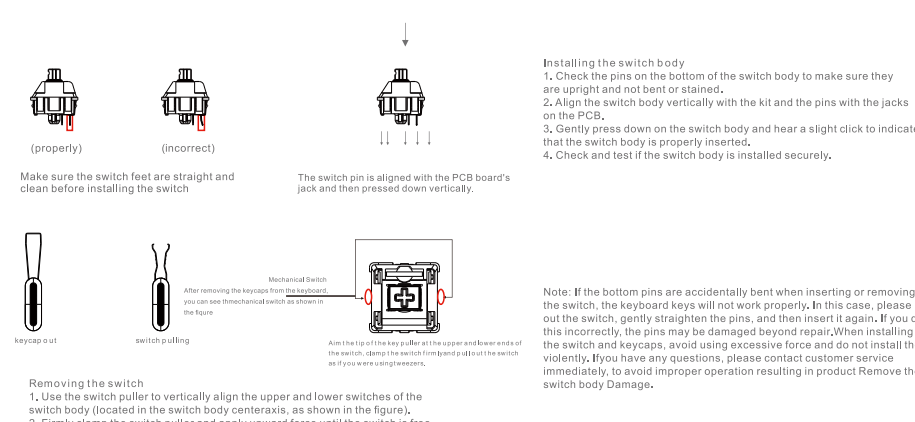

1. Use the switch puller to vertically align the upper and lower shells of the switch body (located in the switch body) and remove the upper shell.
2. Use the switch puller to vertically align the upper and lower shells of the switch body (located in the switch body) and remove the lower shell.
3. Put the switch back carefully.

Note: If the upper plate is accidentally bent after cleaning or removing the switch, the keyboard keys will not work properly. In this case, please use the upper plate and the switch, verify the upper plate, and then insert it again. If you do this incorrectly, the pins may be damaged beyond repair. After removing the switch and cleaning, avoid using excessive force and do not touch the internal components. If you have any questions, please contact customer service immediately. To avoid misoperation resulting in product damage, remove the upper plate carefully.

10

Troubleshooting

- Unable to use Bluetooth
Solution: Please open the Bluetooth settings on your computer or smartphone, select "Keyboard" and delete this device or unpair it. Then, restart your device, turn off and back on the keyboard and try to reconnect again.
- 2.4 GHz or Bluetooth connection is interfered with within 10 meters
Solution: Make sure the keyboard is not placed on a metal surface that may interfere with the wireless signal.
- How to clean the keyboard effectively
*Power off/disconnection: Before cleaning your mechanical keyboard, be sure to disconnect the keyboard from your computer or switch off the power to the keyboard to avoid any potential damage or risk of electric shock.
*Use appropriate tools: Use specialized tools such as soft brushes, air flow canisters or keyboard cleaning gels to clean your keyboard, avoid using sharp or hard objects that may damage the keys or switch.
*Clean gently: Avoid pressing or pulling on the keys during the cleaning process to avoid damaging the keyboard switch.
*Avoid liquids: After cleaning the keyboard, make sure it is completely dry before connecting to the computer to avoid short circuits or other problems.
*Avoid using strong chemical cleaners or solvents that may damage the surface of the keyboard or cause health hazards.
*Clean regularly: Regular cleaning of your mechanical keyboard will maintain its longevity and performance.
By following the above precautions, you can clean your mechanical keyboard more safely and effectively, extending its life and maintaining a good user experience.
- Safety Precautions:
Avoid direct contact with the product, accessories and packaging materials to prevent accidents or choking hazards.
Keep the product dry to avoid moisture and corrosion.
Do not expose the product to extreme temperatures below -10°C (14°F) or above 50°C (